

Installation Details

General Install points

SuperFOIL SF19BB & SF40BB act as both insulation and breathable membrane, there is no need for an additional breather membrane or felt.

SF19BB & SF40BB should be installed with the shiny foil side facing inwards and the fabric breather membrane side facing outwards towards the roof tiles.

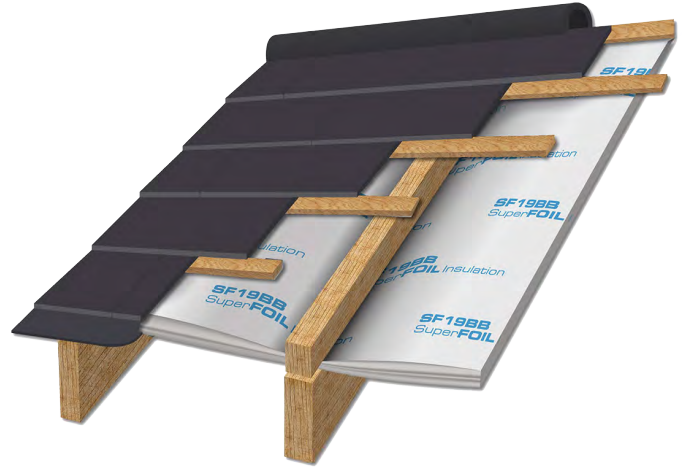

The product should be installed with the stitched edge positioned towards the highest point of the roof with the built-in 100mm overlap nearest the eaves/gutter.

Use the integrated double-sided tape on the overlap to help seal joints and reduce air movement. Additional tape may be required to seal edges and penetrations.

SuperFOIL is lightweight & easy to handle and should be stored indoors or under cover until used.

Once fitted SuperFOIL should be adequately covered within 48 hours.

Fixing Details

SuperFOIL can be fixed using galvanised or stainless staples.

For SF19BB use 14mm staples and for SF40BB 30mm staples should be used.

Installing with vertical counter battens

For SF19BB use 38x50mm counter battens.

For SF40BB use 50x50mm counter battens.

Installing without counter battens

To install the product without counter battens, there must be an adequate clear gap between rafters to drape the SuperFOIL, creating a minimum 10mm runoff under the tile battens.

SF19BB requires minimum 60mm gap required to drape.

SF40BB requires minimum 90mm gap required to drape.

Cutting SuperFOIL

SuperFOIL can be cut using a utility knife, 12" shears or a rotary power cutter.

No special protective equipment is required when installing SuperFOIL breathable products.

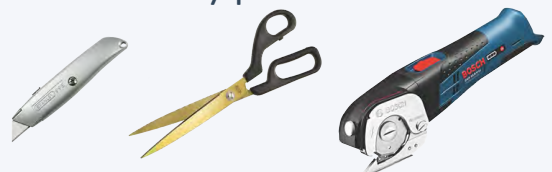

Over Rafter Application

SuperFOIL SF19BB
SuperFOIL SF40BB

Installation Details

Starting at the bottom of the roof at the eaves support tray, Roll out the SuperFOIL across the rafters horizontally.

Staple the start of the roll into place on to your rafter and then continue to roll the product out across the rafters.

If applying tile battens directly to the insulation layer, drape the product between the rafters to create a minimum 10mm run-off gap under the tile battens. (see page 1)

If using counter battens before the tile battens, the insulation should be installed taut whilst being fixed into place to ensure no draping of the product. (counter batten size guide on page 1)

Staple the SuperFOIL to the rafters at approximately 150mm intervals using the correct size staples (see page 1)

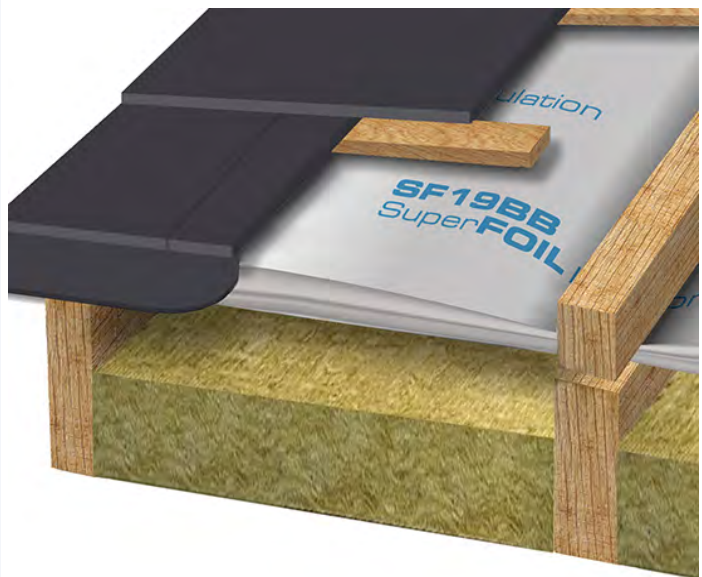
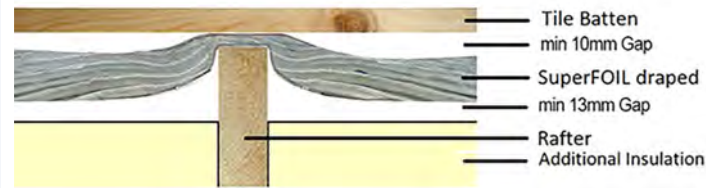

Over Rafter Application

SuperFOIL SF19BB
SuperFOIL SF40BB

Installation Details

Ensuring that the insulation layers extend past the wall plate, use the built in 100mm flap to overlap into the eaves tray and seal by peeling the backing off the integrated double sided tape, and applying even pressure to ensure a tight, secure seal to the eaves tray.

At the end of the roof, turn back the top breathable membrane, exposing the insulation layers and cut them to the correct length so they finish at the outer edge of the roof. Take the top breather membrane layer and wrap it under the cut insulation layers to create a watertight edge. Staple into place on the rafter.

To start a new layer, begin by positioning the built in 100mm overlap above the top of the previous layer and continue with the installation as with the previous layer.

Continue to staple into place along the rafters at minimum 150mm intervals.

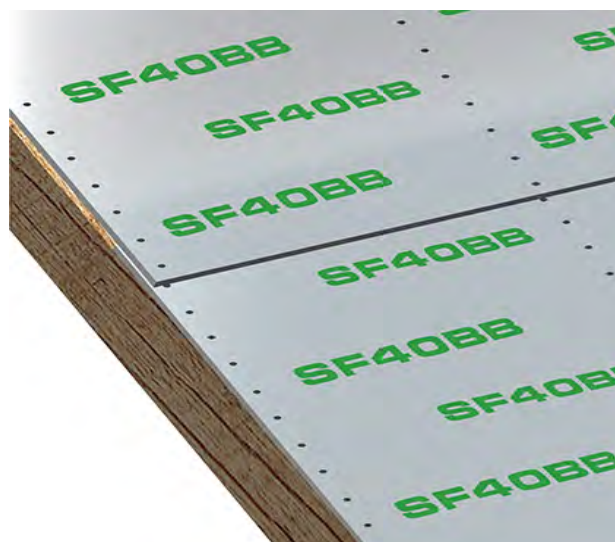
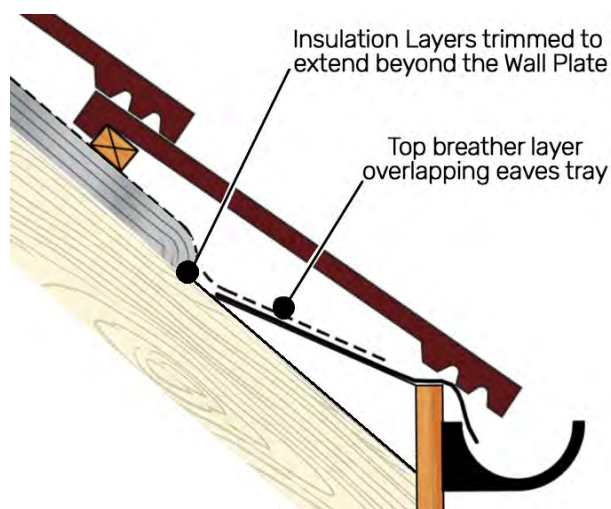

Installation Details

Seal the 100mm overlap to the previously installed roll by removing the backing of the integrated tape and applying pressure to the layers to ensure an even, secure joint.

When finishing a roll in the middle of the roof, turn back the top breathable membrane, exposing the under layers of the insulation and cut them back to the centre of the last covered rafter. (Taking care not to cut or damage to the outer breather membrane layer)

Place the new roll of insulation butt jointed to the cut insulation, secure into place and then place the breathable membrane back over the insulation covering the joint and seal with suitable waterproof tape.

If using counter battens, apply the correct size timber counter battens parallel to the rafters to ensure an adequate air gap is left to allow water runoff under the tile battens.

(counter batten size guide on page 1)

Finish the installation by applying your tile battens as per manufacturer guidelines.

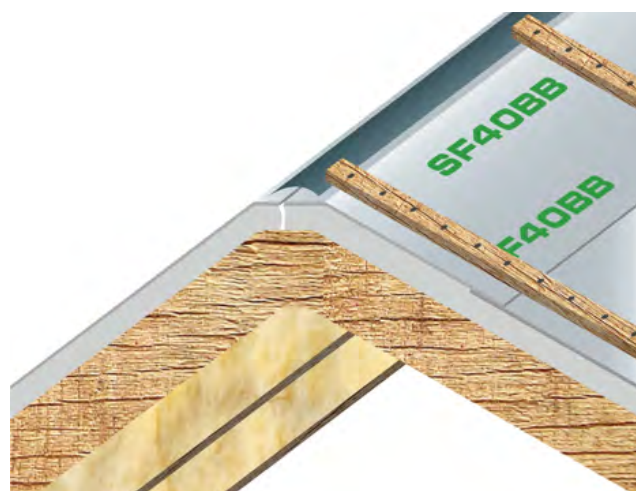
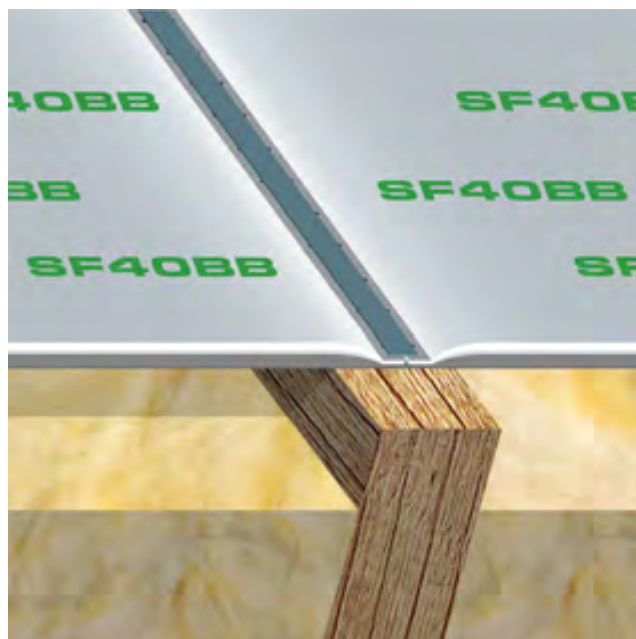

Over Rafter Application

SuperFOIL SF19BB
SuperFOIL SF40BB

Installation Details

Windows & Roof Lights/Lanterns

Roll the SuperFOIL out over the window area. Cut the top layer breathable membrane down the sides and at the corners of the windows

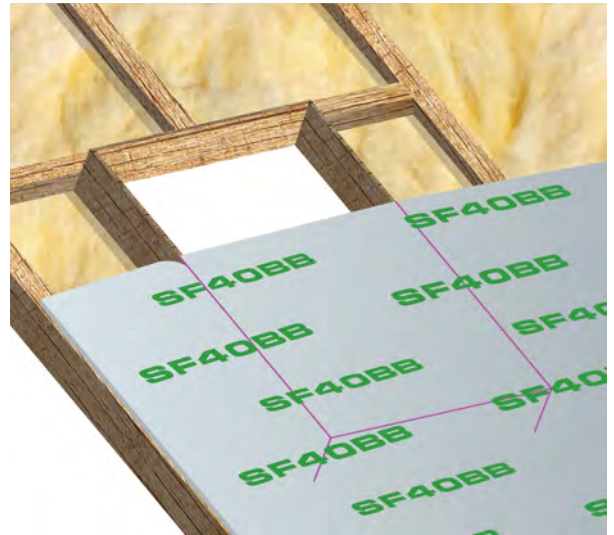

Fold the flaps back from the rest of the insulation layers.

Cut out the remaining layers of insulation around the edge of the window, leaving just the breathable membrane flaps.

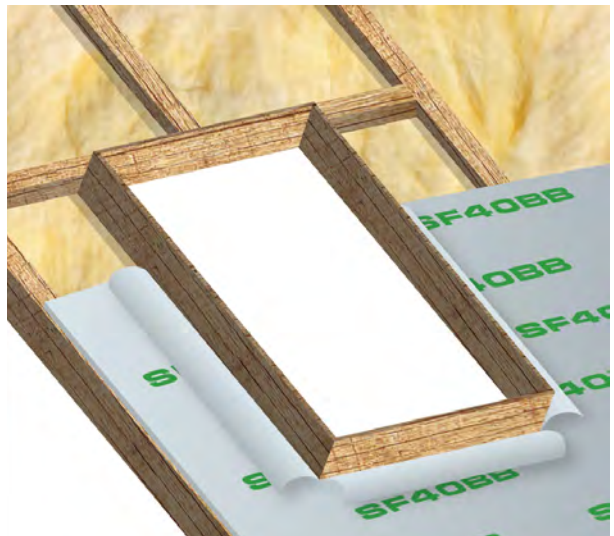

Staple the breathable membrane flaps to the side of the window and then continue to install next layer. Detail the window dressing as per manufacturer's recommendation.

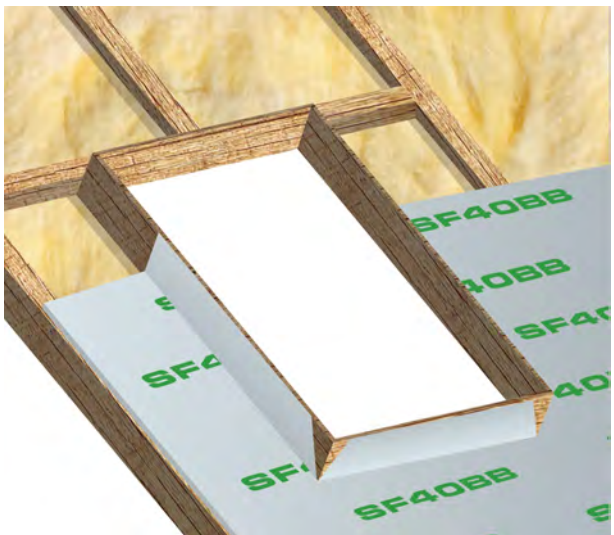

Installation Details

To achieve full performance **SuperFOIL** should be installed with min. 13mm clear air space between the **SuperFOIL** and the next material. This can be achieved by using battens and the available rafter space.

Contact with lead, copper and its alloys should be avoided. **SuperFOIL** should not come into direct contact with bare electrical wiring.

Electrical cables that are surrounded by insulation may need to be de-rated, advice should be sought from a qualified electrician as to the exact requirements.

Any cut, tears or holes in the material should be sealed or repaired as appropriate. For additional guidance, get in touch.

For any further information please contact our technical team

technical@superfoil.co.uk
01636 639900

Whilst we have made every effort to ensure its accuracy, no duty of care is owed to the recipient or any other third party and Boulder Developments Ltd or any of the parties involved, cannot accept liability in respect of the information shown. The specification and installation should therefore be approved by the project management and relevant building control authority before use to ensure that it meets with their specific project requirements. This guidance is intended to assist with installation methods in conjunction with current best practice and compliance with any other aspect of building regulations including Approved Document (fire) should be assessed independently by the relevant authority.